

**Application for a premises licence to be granted
under the Licensing Act 2003**

PLEASE READ THE FOLLOWING INSTRUCTIONS FIRST

Before completing this form please read the guidance notes at the end of the form. If you are completing this form by hand please write legibly in block capitals. In all cases ensure that your answers are inside the boxes and written in black ink. Use additional sheets if necessary.

You may wish to keep a copy of the completed form for your records.

I/We Medmix 2 Limited

(Insert name(s) of applicant)

apply for a premises licence under section 17 of the Licensing Act 2003 for the premises described in Part 1 below (the premises) and I/we are making this application to you as the relevant licensing authority in accordance with section 12 of the Licensing Act 2003

Part 1 – Premises Details

Postal address of premises or, if none, ordnance survey map reference or description			
Mezesphere 74 High Street			
Post town	Epping	Postcode	CM16 4AE

Telephone number at premises (if any)	
Non-domestic rateable value of premises	£28000

Part 2 - Applicant Details

Please state whether you are applying for a premises licence as

Please tick as appropriate

- a) an individual or individuals * please complete section (A)
- b) a person other than an individual *
 - i. as a limited company please complete section (B)
 - ii. as a partnership please complete section (B)
 - iii. as an unincorporated association or please complete section (B)
 - iv. other (for example a statutory corporation) please complete section (B)
- c) a recognised club please complete section (B)
- d) a charity please complete section (B)
- e) the proprietor of an educational establishment please complete section (B)

- f) a health service body please complete section (B)
- g) a person who is registered under Part 2 of the Care Standards Act 2000 (c14) in respect of an independent hospital in Wales please complete section (B)
- ga) a person who is registered under Chapter 2 of Part 1 of the Health and Social Care Act 2008 (within the meaning of that Part) in an independent hospital in England please complete section (B)
- h) the chief officer of police of a police force in England and Wales please complete section (B)

* If you are applying as a person described in (a) or (b) please confirm:

Please tick yes

- I am carrying on or proposing to carry on a business which involves the use of the premises for licensable activities; or
- I am making the application pursuant to a
 - statutory function or
 - a function discharged by virtue of Her Majesty's prerogative

(A) INDIVIDUAL APPLICANTS (fill in as applicable)

Mr <input type="checkbox"/>	Mrs <input type="checkbox"/>	Miss <input type="checkbox"/>	Ms <input type="checkbox"/>	Other Title (for example, Rev)	
Surname			First names		
I am 18 years old or over				<input type="checkbox"/> Please tick yes	
Current postal address if different from premises address					
Post town				Postcode	
Daytime contact telephone number					
E-mail address (optional)					

SECOND INDIVIDUAL APPLICANT (if applicable)

Mr <input type="checkbox"/>	Mrs <input type="checkbox"/>	Miss <input type="checkbox"/>	Ms <input type="checkbox"/>	Other Title (for example, Rev)	
Surname			First names		
I am 18 years old or over				<input type="checkbox"/>	Please tick yes
Current postal address if different from premises address					
Post town				Postcode	
Daytime contact telephone number					
E-mail address (optional)					

(B) OTHER APPLICANTS

Please provide name and registered address of applicant in full. Where appropriate please give any registered number. In the case of a partnership or other joint venture (other than a body corporate), please give the name and address of each party concerned.

Name Medmix Limited
Address 204c High Street Ongar Essex CM5 9JJ
Registered number (where applicable) 08518955
Description of applicant (for example, partnership, company, unincorporated association etc.) Limited Company
Telephone number (if any) 0870 7594410
E-mail address (optional) ayshe@ygtlogistics.com

Part 3 Operating Schedule

When do you want the premises licence to start?

DD		MM		YYYY			
0	3	1	0	2	0	1	3

If you wish the licence to be valid only for a limited period, when do you want it to end?

DD		MM		YYYY			

Please give a general description of the premises (please read guidance note 1)
 Premises are a single storey restaurant facility comprising of a dining area for up to 120 persons, kitchen, serving counter, storage area, toilets, rear courtyard and an area immediately in front of the restaurant for a limited number of tables and chairs.

If 5,000 or more people are expected to attend the premises at any one time, please state the number expected to attend.

What licensable activities do you intend to carry on from the premises?

(Please see sections 1 and 14 of the Licensing Act 2003 and Schedules 1 and 2 to the Licensing Act 2003)

Provision of regulated entertainment

Please tick any that apply

- a) plays (if ticking yes, fill in box A)
- b) films (if ticking yes, fill in box B)
- c) indoor sporting events (if ticking yes, fill in box C)
- d) boxing or wrestling entertainment (if ticking yes, fill in box D)
- e) live music (if ticking yes, fill in box E)
- f) recorded music (if ticking yes, fill in box F)
- g) performances of dance (if ticking yes, fill in box G)
- h) anything of a similar description to that falling within (e), (f) or (g) (if ticking yes, fill in box H)

Provision of late night refreshment (if ticking yes, fill in box I)

Supply of alcohol (if ticking yes, fill in box J)

In all cases complete boxes K, L and M

A

Plays Standard days and timings (please read guidance note 6)			Will the performance of a play take place indoors or outdoors or both – please tick (please read guidance note 2)	Indoors	<input type="checkbox"/>
Day	Start	Finish		Outdoors	<input type="checkbox"/>
Mon			Please give further details here (please read guidance note 3)	Both	<input type="checkbox"/>
Tue					
Wed					
Thur			State any seasonal variations for performing plays (please read guidance note 4)		
Fri					
Sat					
Sun			Non standard timings. Where you intend to use the premises for the performance of plays at different times to those listed in the column on the left, please list (please read guidance note 5)		

B

Films Standard days and timings (please read guidance note 6)			Will the exhibition of films take place indoors or outdoors or both – please tick (please read guidance note 2)	Indoors	<input type="checkbox"/>
				Outdoors	<input type="checkbox"/>
				Both	<input type="checkbox"/>
Day	Start	Finish	Please give further details here (please read guidance note 3)		
Mon					
Tue			State any seasonal variations for the exhibition of films (please read guidance note 4)		
Wed					
Thur			Non standard timings. Where you intend to use the premises for the exhibition of films at different times to those listed in the column on the left, please list (please read guidance note 5)		
Fri					
Sat					
Sun					

C

Indoor sporting events Standard days and timings (please read guidance note 6)			<u>Please give further details</u> (please read guidance note 3)
Day	Start	Finish	
Mon			
Tue			<u>State any seasonal variations for indoor sporting events</u> (please read guidance note 4)
Wed			
Thur			<u>Non standard timings. Where you intend to use the premises for indoor sporting events at different times to those listed in the column on the left, please list</u> (please read guidance note 5)
Fri			
Sat			
Sun			

D

Boxing or wrestling entertainments Standard days and timings (please read guidance note 6)			<u>Will the boxing or wrestling entertainment take place indoors or outdoors or both – please tick</u> (please read guidance note 2)		Indoors	<input type="checkbox"/>
					Outdoors	<input type="checkbox"/>
					Both	<input type="checkbox"/>
Day	Start	Finish	<u>Please give further details here</u> (please read guidance note 3)			
Mon						
Tue						
Wed			<u>State any seasonal variations for boxing or wrestling entertainment</u> (please read guidance note 4)			
Thur						
Fri			<u>Non standard timings. Where you intend to use the premises for boxing or wrestling entertainment at different times to those listed in the column on the left, please list</u> (please read guidance note 5)			
Sat						
Sun						

E

Live music Standard days and timings (please read guidance note 6)			Will the performance of live music take place indoors or outdoors or both – please tick (please read guidance note 2)	Indoors	<input type="checkbox"/>
				Outdoors	<input type="checkbox"/>
Day	Start	Finish	Both		
Mon			Please give further details here (please read guidance note 3)		
Tue					
Wed			State any seasonal variations for the performance of live music (please read guidance note 4)		
Thur					
Fri			Non standard timings. Where you intend to use the premises for the performance of live music at different times to those listed in the column on the left, please list (please read guidance note 5)		
Sat					
Sun					

F

Recorded music Standard days and timings (please read guidance note 6)			Will the playing of recorded music take place indoors or outdoors or both – please tick (please read guidance note 2)	Indoors	<input type="checkbox"/>
Day	Start	Finish		Outdoors	<input type="checkbox"/>
				Both	<input type="checkbox"/>
Mon			Please give further details here (please read guidance note 3)		
Tue					
Wed			State any seasonal variations for the playing of recorded music (please read guidance note 4)		
Thur					
Fri			Non standard timings. Where you intend to use the premises for the playing of recorded music at different times to those listed in the column on the left, please list (please read guidance note 5)		
Sat					
Sun					

G

Performances of dance Standard days and timings (please read guidance note 6)			Will the performance of dance take place indoors or outdoors or both – please tick (please read guidance note 2)	Indoors	<input type="checkbox"/>
				Outdoors	<input type="checkbox"/>
				Both	<input type="checkbox"/>
Day	Start	Finish	Please give further details here (please read guidance note 3)		
Mon					
Tue					
Wed			State any seasonal variations for the performance of dance (please read guidance note 4)		
Thur					
Fri			Non standard timings. Where you intend to use the premises for the performance of dance at different times to those listed in the column on the left, please list (please read guidance note 5)		
Sat					
Sun					

H

Anything of a similar description to that falling within (e), (f) or (g) Standard days and timings (please read guidance note 6)			Please give a description of the type of entertainment you will be providing		
Day	Start	Finish	Will this entertainment take place indoors or outdoors or both – please tick (please read guidance note 2)	Indoors	<input type="checkbox"/>
Mon				Outdoors	<input type="checkbox"/>
				Both	<input type="checkbox"/>
Tue			Please give further details here (please read guidance note 3)		
Wed					
Thur			State any seasonal variations for entertainment of a similar description to that falling within (e), (f) or (g) (please read guidance note 4)		
Fri					
Sat			Non standard timings. Where you intend to use the premises for the entertainment of a similar description to that falling within (e), (f) or (g) at different times to those listed in the column on the left, please list (please read guidance note 5)		
Sun					

J

Supply of alcohol Standard days and timings (please read guidance note 6)			<u>Will the supply of alcohol be for consumption – please tick</u> (please read guidance note 7)	On the premises	<input type="checkbox"/>
				Off the premises	<input type="checkbox"/>
				Both	<input checked="" type="checkbox"/>
Day	Start	Finish	<u>State any seasonal variations for the supply of alcohol</u> (please read guidance note 4)		
Mon	1100	2300			
Tue	1100	2300			
Wed	1100	2300			
Thur	1100	2300			
Fri	1100	2300			
Sat	1100	2300			
Sun	1200	2230	<u>Non standard timings. Where you intend to use the premises for the supply of alcohol at different times to those listed in the column on the left, please list</u> (please read guidance note 5)		

State the name and details of the individual whom you wish to specify on the licence as designated premises supervisor:

Name Irfan Taskiran	
Address Hartley Road Leytonstone London	
Postcode	[REDACTED]
Personal licence number (if known) [REDACTED]	
Issuing licensing authority (if known) London Borough of [REDACTED]	

I

Late night refreshment Standard days and timings (please read guidance note 6)			Will the provision of late night refreshment take place indoors or outdoors or both – please tick (please read guidance note 2)	Indoors	<input type="checkbox"/>
				Outdoors	<input type="checkbox"/>
				Both	<input type="checkbox"/>
Day	Start	Finish	Please give further details here (please read guidance note 3)		
Mon					
Tue					
Wed			State any seasonal variations for the provision of late night refreshment (please read guidance note 4)		
Thur					
Fri			Non standard timings. Where you intend to use the premises for the provision of late night refreshment at different times, to those listed in the column on the left, please list (please read guidance note 5)		
Sat					
Sun					

K

Please highlight any adult entertainment or services, activities, other entertainment or matters ancillary to the use of the premises that may give rise to concern in respect of children (please read guidance note 8).

None

L

Hours premises are open to the public Standard days and timings (please read guidance note 6)			<u>State any seasonal variations</u> (please read guidance note 4)
Day	Start	Finish	
Mon	0900	2300	
Tue	0900	2300	
Wed	0900	2300	
Thur	0900	2300	<u>Non standard timings. Where you intend the premises to be open to the public at different times from those listed in the column on the left, please list</u> (please read guidance note 5)
Fri	0900	2300	
Sat	0900	2300	
Sun	1200	2230	

M Describe the steps you intend to take to promote the four licensing objectives:

a) General – all four licensing objectives (b, c, d and e) (please read guidance note 9)

All staff engaged in the sale of alcohol will be trained in respect of their legal and social responsibilities whilst doing so. They will also be trained in the contents of the premises licence including any conditions contained therein.

A record of all staff training provided shall be maintained by the premises licence holder, and shall be produced for inspection by the police or authorised officers of the licensing authority upon request.

b) The prevention of crime and disorder

Alcohol shall only be sold to persons who are dining at the restaurant, either inside the premises, in the rear courtyard or in the area immediately in front of the premises.

No alcohol shall be taken from the premises in open containers.

Off sales of alcohol will be restricted to persons who have been customers of the restaurant only. Any alcohol taken from the premises shall be taken in sealed containers only.

c) Public safety

Staff shall be trained in respect of the fire risk assessment, and the health and safety risk assessment.

First aid facilities shall be provided at the premises.

d) The prevention of public nuisance

Customers who wish to smoke at the premises will be permitted to do so in the courtyard at the rear of the premises, or in the area immediately in front of the premises.

A notice will be displayed requesting persons who are using the outside areas to do so quietly, respecting the needs of the local community.

A notice shall be displayed requesting customers who are leaving the premises to do so quietly, respecting the needs of the local community.

e) The protection of children from harm

The premises shall operate 'Challenge 25' as its age verification policy and staff shall be trained in respect of this policy.

The only forms of acceptable identification shall be a photo style driving licence, a passport, an ID card bearing the PASS logo in a hologram format, military ID and official European ID cards.

A notice shall be displayed at the premises to advise customers that Challenge 25 is in operation.

Checklist:

Please tick to indicate agreement

- I have made or enclosed payment of the fee.
- I have enclosed the plan of the premises.
- I have sent copies of this application and the plan to responsible authorities and others where applicable.
- I have enclosed the consent form completed by the individual I wish to be designated premises supervisor, if applicable.
- I understand that I must now advertise my application.
- I understand that if I do not comply with the above requirements my application will be rejected.

IT IS AN OFFENCE, LIABLE ON SUMMARY CONVICTION TO A FINE NOT EXCEEDING LEVEL 5 ON THE STANDARD SCALE, UNDER SECTION 158 OF THE LICENSING ACT 2003, TO MAKE A FALSE STATEMENT IN OR IN CONNECTION WITH THIS APPLICATION.

Part 4 – Signatures (please read guidance note 10)

Signature of applicant or applicant's solicitor or other duly authorised agent (see guidance note 11).
If signing on behalf of the applicant, please state in what capacity.

Signature	
Date	3 rd September 2013
Capacity	Licensing Consultant

For joint applications, signature of 2nd applicant or 2nd applicant's solicitor or other authorised agent (please read guidance note 12). **If signing on behalf of the applicant, please state in what capacity.**

Signature	
Date	
Capacity	

Contact name (where not previously given) and postal address for correspondence associated with this application (please read guidance note 13)

Frank Fender
FJF Licensing Solutions
10 Highfield Close

Post town	Newport Pagnell	Postcode	MK16 9AZ
-----------	-----------------	----------	----------

Telephone number (if any)	07846 747833
---------------------------	--------------

If you would prefer us to correspond with you by e-mail, your e-mail address (optional)
frank@fjflicensingsolutions.co.uk



Certificate of Service

I, Frank Fender in the firm of FJF Licensing Solutions of 10 Highfield Road, Newport Pagnell, Buckinghamshire MK16 9AZ refer to the following:

1. Letter to Epping Forest District Borough Council dated 3rd September 2013
2. Application Form
3. Copy of plans
4. Consent of Designated Premises Supervisor
5. Cheque in the sum of £190.00

I CERTIFY that I have served documents 1-5 upon the following:

1. Licensing Unit, Epping Forest District Council, Civic Offices, High Street, Epping, Essex CM16 4BZ (Att; Mrs K Tuckey)

I FURTHER CERTIFY that I have served a true copy of documents 1-4 upon the following:

2. Health and Safety Unit, Epping Forest District Council, Civic Offices, High Street, Epping, Essex CM16 4BZ (Att; Steve Harcher)
3. Peter Jones, Epping and Brentwood Licensing Officer, Epping Police Station, 230 High Street, Epping, CM16 4AP.
4. Head of Child Protection, (Licensing Applications), Essex County Council, PO Box 297, County Hall, Chelmsford, Essex CM1 1YS.
5. Essex Fire and Rescue Service, Harlow and Epping Community Command, Harlow Service Delivery Point, Fourth Avenue, Harlow, Essex CM20 1DU.
6. Planning Services, Epping Forest District Council, Civic Offices, High Street, Epping, Essex CM16 4BZ (Att; David Baker).
7. Trading Standards, New Dukes Way Office, 2 Beaufort Road, Dukes Park Industrial Estate, Chelmsford, Essex CM2 6PS (Att; Sue Carroll).
8. Environment and Neighbourhoods Group, Epping Forest District Council, Civic Offices, High Street, Epping, Essex CM16 4BZ (Att; Richard Gardiner).
9. Licensing Administration, Public Health, North Essex Cluster, Essex County Council, A1 Block, Market Road, Chelmsford, CM1 1QH.

I effected service by sending the said documents by post, to each and every one of them on 3rd September 2013

Signed.....

1991

Consent of individual to being specified as premises supervisor

I IRFAN TASKIRAN
[full name of prospective premises supervisor]

of [REDACTED] HARTLEY ROAD
LEYTONSTONE
LONDON
[REDACTED]
[home address of prospective premises supervisor]

hereby confirm that I give my consent to be specified as the designated premises supervisor in relation to the application for

NEW PREMISES LICENCE
[type of application]

by MEDMIX 2 LIMITED
[name of applicant]

relating to a premises licence N/A
[number of existing licence, if any]

for MEZESPHERE
74 HIGH STREET
EPPING
CM16 4AE
[name and address of premises to which the application relates]

and any premises licence to be granted or varied in respect of this application made by

MEDMIX 2 LIMITED

[name of applicant]

concerning the supply of alcohol at

MEZESHERE
74 HIGH STREET
EPPING
CM16 4AE

[name and address of premises to which application relates]

I also confirm that I am applying for, intend to apply for or currently hold a personal licence, details of which I set out below.

Personal licence number

[REDACTED]

[insert personal licence number, if any]

Personal licence issuing authority

LONDON BOROUGH OF [REDACTED] [REDACTED]

[insert name and address and telephone number of personal licence issuing authority, if any]

Signed

[REDACTED]

Name (please print)

IRFAN TASKIRAN

Date

09.04.2013

11

12



Scale: 1:100

Notes

All dimensions to be checked by the Contractor before construction proceeds.
 This drawing is the property of IntelliArch. Labels and notes are to be copied
 and reproduced without charge for your own use.

NO.	REV.	DATE

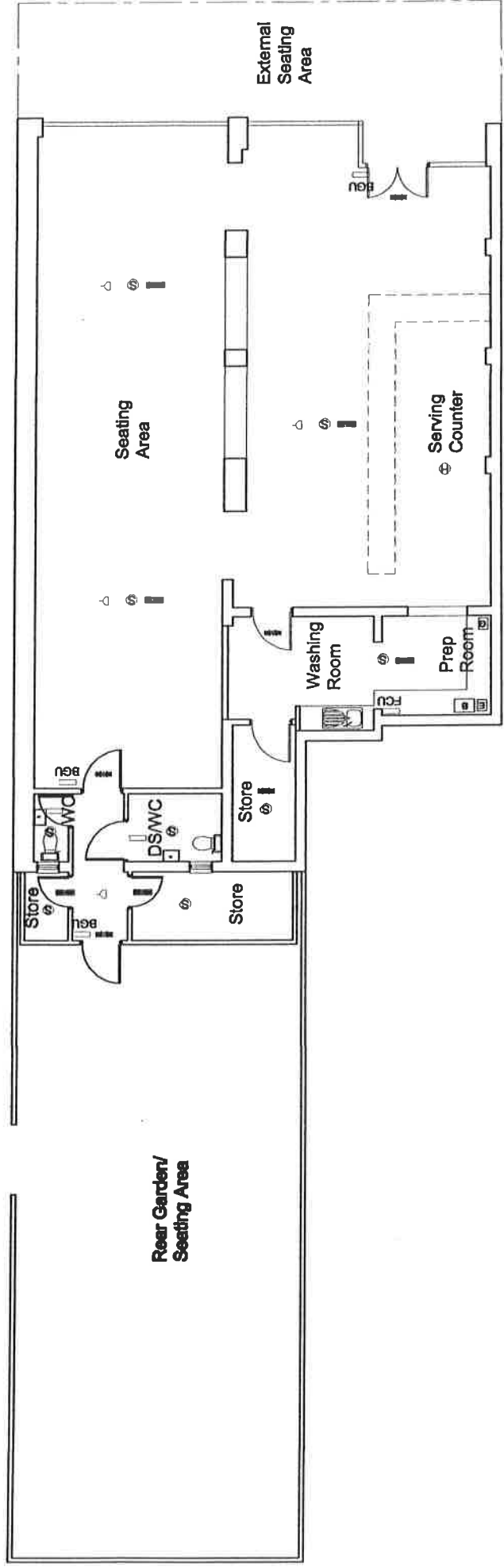

Ground Floor Plan

- Key**
- Emergency lighting
 - ⊕ Emergency illuminated exit sign
 - ⊕ Smoke detectors
 - ⊕ Heat detectors
 - FCU Fire control unit
 - BGU Break glass unit
 - ▷ Fire alarm sounder
 - E Electric
 - G Gas
 - B Boiler

IntelliArch Ltd

28 Finsbury Avenue, London, EC2A 3DF
 T: 020 4620 2222 E: info@intelliarch.co.uk
 W: www.intelliarch.co.uk

74-76 High Street
 Epping Essex CM18 4AE

Proposed Floor Plans

1:100 @ A3
 September 2013

1057-20

Essex County Council

(Fyfield Road, Willingale)

Temporary Prohibition of Traffic Order 2013
Notice is hereby given that the Essex County Council has made the above Order under Section 14(1) of the Road Traffic Regulation Act 1984.

Effect of the order: To temporarily close that length of Fyfield Road, Willingale in the District of Epping Forest, from its junction with The Street, east for a distance of approximately 250 metres.

The closure is scheduled to commence on 18 September 2013 for 2 days or where appropriate signs are showing and weather permitting. The closure is required for the safety of the public and workers while cabling works is undertaken by BT.

The alternative route will be via Spains Hall Road - Pigstye Green Road - Bassatts Lane - Chelmsford Road - High Ongar Road - Fyfield Road - Ongar Road - Queens Street - Willingale Road - Fyfield Road and vice versa.

Access for emergency service vehicles and pedestrians will be maintained at all times during the closure.

The Order will come into effect on 18 September 2013 and may continue in force for 18 months or until the works have been completed, whichever is the earlier.

Liz Burr, Head of Network Management, County Hall, Chelmsford.

Section 53 Wildlife and Countryside Act 1981 Definitive Map and Statement for the County of Essex

The Essex County Council Definitive Map Modification No. 558 (Footpath 7, Theydon Mount, Epping Forest District) Order 2013

The above Order made on 14th August 2013, if confirmed as made, will modify the Definitive Map for the area by:

1. Deleting a section of Footpath 7 Theydon Mount from the northern end of Footpath 7, near the southern point of Beachet Wood, travelling southwards in the parish of Stapleford Tawney, then westwards into the parish of Theydon Mount where it reaches the unaffected part of Footpath 7.
2. Adding a footpath 1.5 metres wide, to be known as part of Footpath 7 Theydon Mount, travelling from the unrefined part of the footpath northwards within the parish of Theydon Mount, until reaching near the southern point of Beachet Wood, where it crosses the parish boundary to continue as Footpath 3, Stapleford Tawney.

A copy of the Order and the Order map may be seen free of charge during normal office hours at Epping Forest District Council, Civic Offices, High Street, Epping, CM16 4BZ and at the Chelmsford Library, Market Road, where copies will be available on request at a charge.

Any representation or objection relating to the Order must be sent in writing to the Head of Essex Legal Services, Essex County Council, County Hall, Chelmsford, CM1 1LX, to arrive not later than 1st November 2013 and it is requested that the grounds on which it is made are stated.

If no representations or objections are duly made to the Order, or if any so made are withdrawn, the Essex County Council, instead of submitting the Order to the Secretary of State, may itself confirm the Order. If the Order is submitted to the Secretary of State for the Environment, Food and Rural Affairs, any representations or objections, which have been duly made and not withdrawn, will be sent with it.

P M Thomson, County Solicitor, Essex Legal Services, New Bridge House, 60-68 New London Road, Chelmsford, Essex CM2 0PD.
Dated: 12 September 2013.



Redbridge

LONDON BOROUGH OF REDBRIDGE

The Redbridge (Waiting & Loading) (Amendment No. 7) Traffic Order 2013

The Redbridge (Parking) (Amendment No. 7) Traffic Order 2013

NOTICE IS HEREBY GIVEN that, on the 11 September 2013 the Council of the London Borough of Redbridge made the above-mentioned Orders under sections 6, 45, 46, 49, 124 and part IV of Schedule 9 of the Road Traffic Regulation Act 1984 ("the Act") and of all other enabling powers. The effect of the Order will be to introduce waiting, loading and parking restrictions as specified in the Schedules to this notice.

A copy of the Orders, which will come into operation on the 16 September 2013, of a plan of the relevant roads and the Council's statement of reasons for making the Order can be inspected between 9.45am and 4.30pm on Mondays, Tuesdays, Thursdays and Fridays, and on Wednesdays between 9.30am and 4.30pm (except on Bank Holidays), for a period of six weeks from the date on which this notice is published at the Information Centre, Lynton House, 255-259 High Road, Ilford, Essex IG1 1NN.

Any person wishing to question the validity of the Order or any of its provisions on the grounds that it is not within the relevant powers of the Road Traffic Regulations Act 1984 or that any of the relevant requirements thereof or of any regulations made there under have not been complied with in relation to the Order may, within six weeks of the date on which the Order was made, make application for the purpose to the High Court.

Dated 12 September 2013

Dave Cuthell Chief Highways and Cleansing Officer

Lynton House, 255 - 259 High Road, Ilford, Essex, IG1 1NY

Schedule 1 - Waiting Restrictions operative at all times

Babbacombe Gardens	Junction with Chestnut Walk	Outside	Coniston Gardens, Derwent Gardens & Keswick Gardens
Chestnut Walk	Outside	Woodford Police Station	
Civic Way	Junction with	St Thomas Court Access Road	
Falmouth Gardens	Junction with	Torquay Gardens	
Horns Road	Junction with	New Mossford Way	
Mighell Avenue	Junction with	Fowey Avenue	
Roding Lane	Between	Avondale Crescent & The Mews	
South Gardens	Junction with	Derwent Gardens, Keswick Gardens & Access road to rear of Nos. 2 to 60 Widcombe Gardens	

Schedule 2 - Waiting Restrictions operative Monday to Friday 9.30am to 10.30am
Redbridge Lane Outside
No. 42 Redbridge Lane West

Schedule 3 - Waiting Restrictions operative Monday to Friday 1pm to 2pm
Roding Lane Between
Avondale Crescent & Vista Drive South

Schedule 4 - Pay & Display operative Monday to Saturday 9.30am to 6.30pm
The Broadway Outside
Nos. 13 & 14 The Broadway

Schedule 5 - No Stopping on School Keep Clear Markings operative Monday to Friday 8am to 9.30am and 2pm to 4pm
Balfour Road Outside
Christchurch Primary School

www.redbridge.gov.uk

GREEN
Bright spacious room in shared apartment, suit N/S professional female, modern facilities, cleaner bills included
£480 pcm
07955 663578

Studio apartment:
GCH; shower, own garden, near station, private block.
NO DSS
£736 pcm
07582 664442

Underground station & shops. Suit tidy adult.
No DSS.
Free parking.
07980 613 596

LOUGHTON
Double Room to let, single occupancy for professional person, all amenities (TV, mins), tube/leisure centre/forest/shops etc. Smokers welcome.
£480 pcm inc bills. Deposit required. No DSS
07946 652365

WALTHAMSTOW
Single rooms to let in recently refurbished house. 5 mins from Blackhorse Lane
£425 pcm
07971 645528

Property Wanted

ALL TYPES OF PROPERTY WANTED
For lease and for refurbishment
Free Management.
We can refurbish your property when leasing.
All maintenance and refurbishments/building works covered.
Please call for more information on our services.
020 3683 2694

more property classified on page 46

Public Notices

Planning applications affecting a Conservation Area or Setting of a listed building
Epping Forest District Council
07582 664442

GREEN
Bright spacious room in shared apartment, suit N/S professional female, modern facilities, cleaner bills included
£480 pcm
07955 663578

Studio apartment:
GCH; shower, own garden, near station, private block.
NO DSS
£736 pcm
07582 664442

Underground station & shops. Suit tidy adult.
No DSS.
Free parking.
07980 613 596

LOUGHTON
Double Room to let, single occupancy for professional person, all amenities (TV, mins), tube/leisure centre/forest/shops etc. Smokers welcome.
£480 pcm inc bills. Deposit required. No DSS
07946 652365

WALTHAMSTOW
Single rooms to let in recently refurbished house. 5 mins from Blackhorse Lane
£425 pcm
07971 645528

Property Wanted

ALL TYPES OF PROPERTY WANTED
For lease and for refurbishment
Free Management.
We can refurbish your property when leasing.
All maintenance and refurbishments/building works covered.
Please call for more information on our services.
020 3683 2694

Planning applications affecting a Conservation Area or Setting of a listed building
Epping Forest District Council
07582 664442

Area or Setting of a listed building
EPP/16307/13 1 Cowdrell Mill Mews, Waltham Abbey, EN9 1JG
Front extension. EPP/1728/13 The Old Mill House, Batts Lane, Waltham Abbey, EN9 2DA. Demolish bungalow and replace with one and half storey dwelling. EPP/1793/13 The Cook The Street, Sheering, CM22 7JF. Variation of condition 2 of planning permission EPP/2366/07 (Erection of a detached dwelling to be used for a care home). EPP/1720/13 Little Thimbley, 104 Hill Road, Ongar, CM5 9LQ. Swimming pool and pool house. EPP/1770/13 16 Great Stony Park High Street, Ongar, CM5 0TR. Conversion of outbuilding into ancillary accommodation.
Major Application or of wider concern/Departure from Local Plan
EPP/1716/13 Former Bank Of England Sports Ground, Langston Road, Loughton, IG10 0DA. Centre Building and substation. EPP/1784/13 Knowley Nursery, Hick Hill, Waltham Abbey, EN9 3LF. Outline application (with appearance, landscaping layout and scale reserved) for redevelopment of site to provide 105 residential units 85% affordable, associated parking, access road, amenity areas and community facility with shop. Access to be determined.
Works to Listed Buildings
EPP/1706/13 Nazeing Upper Town Cottage, Batts Lane, Nazeing, EN9 2DA. Conversion of barn into a new dwelling. EPP/1817/13 Dyers Stamford Rivers Road, Ongar, CM5 9BT. Single storey rear orangery, detached garage, demolition of existing conservatory and garage and minor alterations. EPP/1862/13 Ashby Pavilion, 44 Sim Street, Waltham Abbey, EN9 1EJ. Change of use of ground floor from A1 (retail) to A1 (leisure) and mixed use to include beauty therapy (Spa Genesis).
Comment online at www.eppingforestdc.gov.uk/Plan, or in writing to Director of Planning, Epping Forest District Council, Civic Offices, High Street, Epping, CM16 4BZ by 27/09/13
For householders applications, make comments clear and full, because there is no opportunity again if it becomes an appeal.

PUBLIC NOTICE
LICENSING ACT 2003
Notice is given this day, 6th September 2013, that MEDMIX 2 LIMITED of 204C HIGH STREET, ONGAR, ESSEX CM5 9AJ has applied to the Licensing Officer of Epping Forest District Council for a premises licence in respect of MEDMIX/EP/174 HIGH STREET, EPPING, CM16 4AE. The proposed licence is for the retail sale of alcohol from 1100hrs to 2300hrs Monday to Saturday and from 1200hrs to 2300hrs Sunday.
The holder of licensed premises is maintained at the Licensing Office of Epping Forest District Council, Civic Offices, High Street, Epping, Essex CM16 4BZ. Applications for premises licences may be inspected at this office during office hours. Any person wishing to oppose this application must give written notice to the Licensing Officer within 28 days of this notice. It is an offence knowingly or recklessly to make a false statement in connection with an application which could lead to a fine on summary conviction (maximum £5,000).



Corporate Support

Licensing Department, Epping Police Station
230 High Street, Epping, CM16 4AP

Telephone 01279 625 405 Facsimile: 01279 625 440

Website: www.essex.police.uk Email: Peter.Jones@essex.pnff.police.uk

Civic Offices High Street
Epping Essex CM16 4BZ

Telephone: 01992 564000

Facsimile: 01992 578018

DX: 40409 Epping

Director of Corporate Support
Services Colleen O'Boyle
Solicitor to the Council

Enquiries to:

Mrs Kim Tuckey
Licensing Department
Epping Forest District Council
Civic Offices
High Street
Epping
CM16 4BZ

23 September 2013

Dear Kim,

LICENSING ACT 2003 – GRANT OF PREMISES LICENCE SECTION 17

NEW PREMISE: Mezesphere, 74 High Street, Epping

DPS: Irfan Taskiran

APPLICANT: Medmix 2 Limited via FJF Licensing Solutions

Further to the above application for the Grant of a Premises Licence received on 4 September 2013. I can now confirm that all my checks have been carried out and can confirm that Essex Police will not be making any representations or objections to this application in respect of the licensing objectives.

I trust the aforementioned will assist and look forward to receiving a copy of the Licence, if/when processed, in due course.

Yours sincerely,

Mr Peter Jones ABII
Epping & Brentwood Licensing Officer
West LPA

Cc. Mr F Fender
FJF Licensing Solutions
10 Highfield Close
Newport Pagnell
Buckinghamshire
MK16 9AZ



Essex County Fire & Rescue Service

Mr David Johnson LL.B(Hons), BSc, MA, MSc, FCM
Chief Fire Officer & Chief Executive



WEST AREA COMMAND
Harlow Service Delivery Point
Fourth Avenue
HARLOW
CM20 1DU
☎ 01279 420841
✉ he.command@essex-fire.gov.uk

Safety & Licensing Officer
Safety & Licensing Dept
Epping Forest District Council
Civic Offices
High Street
Epping
Essex
CM16 4BZ

Date: 5th September 2013
Our Ref: GM/KC/FP/89/4979
Your Ref:
Enquiries to: Geoff Marler
Workplace Fire Safety Officer

Dear Sir/Madam,

LICENSING ACT 2003
THE REGULATORY REFORM (FIRE SAFETY) ORDER 2005
Premises: Mezesphere, 74 High Street, Epping, CM16 4AE

Receipt is acknowledged of the above consultation, which will be audited by the Essex Fire Authority (The Authority).

Should there be any significant concerns regarding the application you will be notified in due course.

Yours faithfully

Geoff Marler
Fire Safety Officer



Licensing Applications
Children's Safeguarding Service
Schools Children's and Families Service
A Block 202, County Hall
Chelmsford CM1 1YS
Tel: 01245 436744
Email: LicenceApplications@essex.gov.uk

Frank Fender
FJF Licensing Solutions
10 Highfield Close
Newport Pagnell
Buckinghamshire
MK16 9AZ

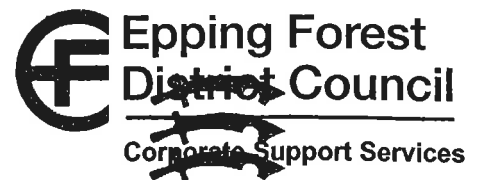

Essex County Council
Civic Offices High Street
Epping Essex CM16 4BZ
Telephone: 01992 564000
Facsimile: 01992 578018
DX: 40409 Epping

Director of Corporate Support
Services Colleen O'Boyle
Solicitor to the Council

Enquiries to:

Your ref: FJFLS/FF/42/13
Our ref: 09-2013/5
Date: 23 September 2013

Dear Frank

RE: Licensing Act 2003: Mezesphere 74 High Street Epping CM16 4AE

The licensing application received on 4th September 2013 has been assessed and we can confirm we have no objections to this licence application.

Yours sincerely

Paula Stacey
Service Manager Safeguards,
Children's Safeguarding Service



EssexWorks.

For a better quality of life



12 September 2013

Epping Forest District Council,
Corporate Support Services,
Civic Offices,
High Street,
Epping,
Essex. CM16 4BZ

Attn: The Senior Licensing Officer

Dear Sir,

**Notification of Consultation – An Application in respect of Premises Licence
At proposed new restaurant 74 High Street, Epping, Essex. CM16 4AE**

I am writing to object in the strongest possible terms to the proposed application of a Licence for On and Off Sales of Alcohol at the above premises. My reasons for this objection are on the grounds of “Prevention of crime and disorder”, and “The prevention of public nuisance”.

I live next door to this proposed restaurant, above the Tile Shop at 68-70 High Street where I own and occupy one of the two flats above. I am fully aware of the pitfalls and disadvantages of living on the High Street and above a shop, but that is the whole point. The shop next door has for all of the duration of my occupation since 1984 been a furniture shop, and that and the other shops around close at 5.30 p.m. so when I get home from work there is no noise or disturbance from the shops. If a restaurant is to open that will mean my enjoyment of quiet evenings will be shattered, as it will be open for business until 11.00 p.m. every night, with all the attendant noise, cooking smells, and cars parking outside.

The area at this end of the High Street is mixed residential and retail, and I would not have chosen to live above a shop that was next door to a restaurant. There is already a restaurant, Restobistro, two properties down to my right, and I get cooking smells from there wafting in through my open windows, and also from the Chinese and Indian Restaurants opposite. There is also a Fish & Chip Shop and Domino Pizza on the other side of the road. All of these food outlets combine to make this end of the High Street a saturation point with regard to places to eat.

The proposal to have a Licensed On and Off Sales Restaurant selling alcohol all day from 11.00 a.m. to 11.30 p.m. is to my mind unnecessary, especially as there is a public house 100 yards away, and will spoil my enjoyment by having noise and nuisance right outside my front windows. Also I would imagine that there would have to be some kind of flue at the rear of the restaurant to take the cooking fumes away and that would be right in my view from my kitchen window, which is not

2000

acceptable. If the restaurant is open for sale of alcohol up to 11.00 p.m. at night I can imagine the noise and fumes from this flue would penetrate my windows making it intolerable to have any windows open at the back of my flat.

There are also no parking facilities outside the shop as the lay-by there is a Bus Stop. Cars visiting neighbouring restaurants tend to park on the pavement especially at weekends. If a Licence to sell Alcohol is granted I can visualize cars coming and going all evening especially at weekends, which will only add to the nuisance, and further noise from patrons of the restaurant leaving late at night, and rubbish and litter being dumped along the alleyway to my front door. This happens anyway at times when the pub shuts, and also the Night Club, Billie Jeans, when it shuts at around 1.00 a.m., so another place for partygoers and revellers making a noise as they pass by under my windows, is a public nuisance and therefore unacceptable and should not be allowed to happen.

Yours faithfully,

Mrs. G.M. Godden

